

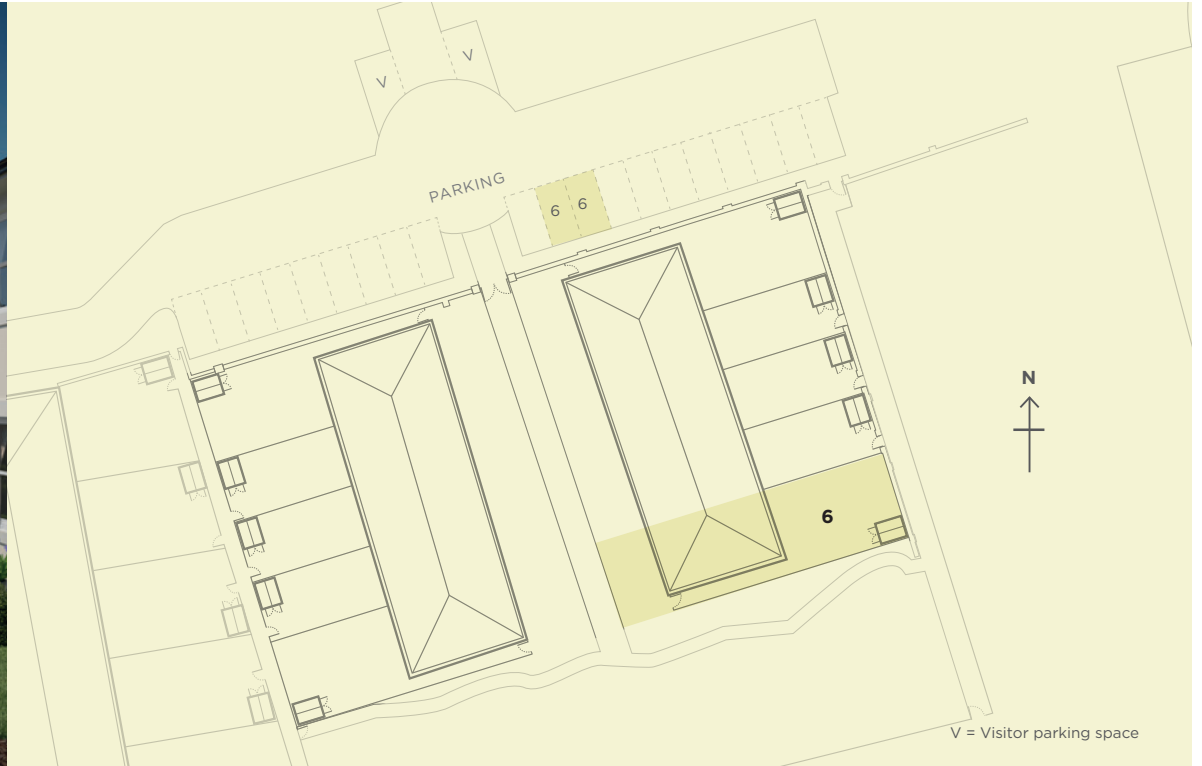

FRITH PARK

WALLED GARDENS

NO. 6
THREE BEDROOM END-OF-TERRACE HOME



Savills Guildford
244-246 High St, Guildford GU1 3JF

01483 796810

KEY: C Cupboard W Fitted wardrobe L Loft hatch access to boarded loft area with ladder and light

This information is for guidance only. The dimensions given are subject to minor variations (+ or - 5%) and are not intended to be used for carpets sizes, appliance sizes or items of furniture. Furniture shown is not included and are shown as indicative only. Details contained here may change and should not be relied upon as statements of fact or representation and applicants must satisfy themselves by inspection or otherwise as to their correctness. This information does not constitute a contract or warranty.

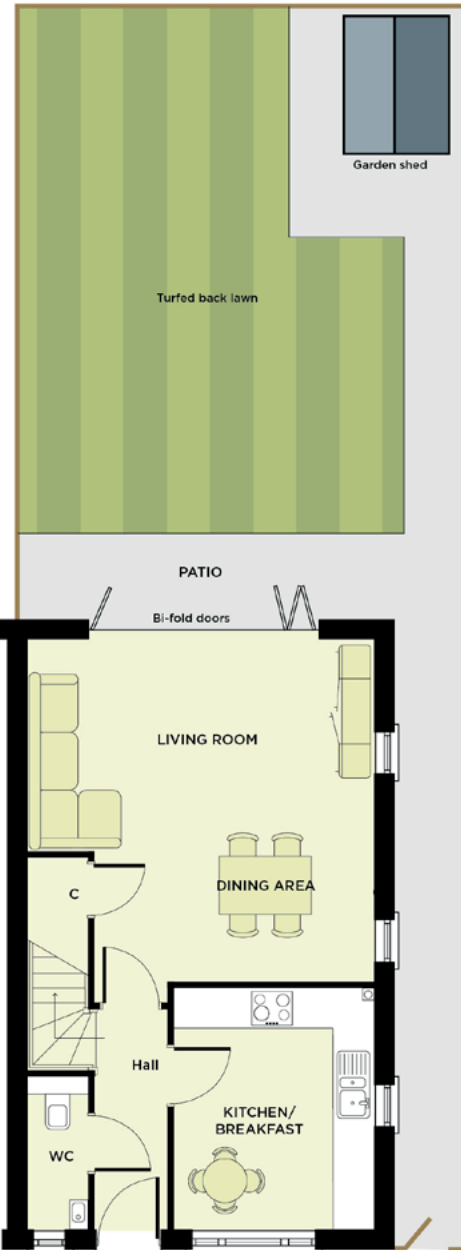

6 WALLED GARDENS

This three bedroom end-of-terrace home offers light and airy living space with a generous living and dining area with bi-fold concertina doors that open up the whole area directly onto the large turfed garden, complete with shed, and an open outlook. The separate kitchen/breakfast room comes complete with fitted appliances. Upstairs are three bedrooms, the master bedroom includes an ensuite and walk-in shower and fitted wardrobes. The loft hatch offers some extra storage in the partially boarded loft complete with ladder and light. The home comes with two parking spaces.

INTERIOR DECOR: Foxglove

GROUND FLOOR

Kitchen	3.60m x 2.98m
	11'08" x 9'09"
Living /Dining room	5.40m x 5.21m
	17'08 x 17'01"

FIRST FLOOR

Master Bedroom	3.58m x 2.81m
	11'09" x 9'03"
Bedroom Two	3.28m x 2.96m
	10'09" x 9'08"
Bedroom Three	3.28m x 2.12m
	10'09" x 6'11"

TOTAL FLOOR AREA 92m² 985 ft²

PARKING Two allocated spaces.

